

## 64659 250 W 24 V

Halogen lamps with reflector MR16



### Product features

- Xenon instead of krypton as the filler gas (XENOPHOT HLX versions)
- Luminous flux up to 10 % higher with same power consumption (XENOPHOT HLX versions)



## Technical data

### Electrical data

Nominal wattage	250.00 W
Nominal voltage	24.0 V

### Photometrical data

Color temperature	3200 K
Nominal luminous flux	400 lm

### Light technical data

Focal length	35.0 mm
--------------	---------

### Dimensions & weight

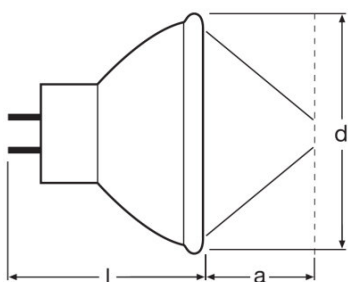

Diameter	51.0 mm
Length	44.5 mm

### Lifespan

Lifespan	1000 h
----------	--------

### Additional product data

Coating	Dichroic
Base (standard designation)	GX5.3

### Capabilities

Burning position	Any
------------------	-----

### Certificates & standards

EEI – Energy Label	B
--------------------	---

Product datasheet

Country specific categorizations

ANSI code	ELC-10
Order reference	64659 ELC-10 25

Country specific information

Product code	METEL code	SEG-No.	STK-Number	UK Org
4008321197795	OSRH64659	-	-	-

## Product datasheet

---

### Logistical Data

Product code	Product description	Packaging unit (Pieces/Unit)	Dimensions (length x width x height)	Volume	Gross weight
4008321197795	64659 250 W 24 V	Folding carton box 1	58 mm x 46 mm x 46 mm	0.12 dm <sup>3</sup>	32.00 g
4008321197801	64659 250 W 24 V	Shipping carton box 20	282 mm x 122 mm x 356 mm	12.25 dm <sup>3</sup>	810.00 g

The mentioned product code describes the smallest quantity unit which can be ordered. One shipping unit can contain one or more single products. When placing an order, for the quantity please enter single or multiples of a shipping unit.

---

### References / Links

For further technical information please refer to the following OSRAM brochure:

“Technology and applications, Low-voltage tungsten-halogen lamps”

“Halogen lamps, low and medium voltage for entertainment, technical and medical applications” cross reference list

---

### Disclaimer

Subject to change without notice. Errors and omission excepted. Always make sure to use the most recent release.