



DOUGHTY ENGINEERING LTD

DATA SHEET

TITLE: SOLID JOINER

PART NOS:
T25108 - SILVER
T2510801 - BLACK

MATERIAL:
STEEL

WEIGHT:
2.64 KG

SWL:

FINISH:
T25108 - ZINC PLATED
T2510801 - BLACK POWDER PAINT

NOTES:

STRICTLY FOR REFERENCE PURPOSES ONLY

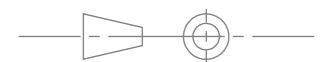

THIRD ANGLE PROJECTION

